

LOS ANGELES COUNTY
DEPARTMENT OF PUBLIC WORKS
BENCH MARK LIST



LA MIRADA QUAD

2000 ADJUSTMENT

**NAVD 88 DATUM
METRIC**

OFFICE COPY

PREFACE

The Department of Public Works level net is composed of more than 1,700 miles or 2720 kilometers of levels supporting in excess of 9,000 bench marks. Previously when a major readjustment of the net was undertaken, to emphasize the complete break with previous elevations, the CY, CG, & CL, series bench marks were re-labeled DY, DG, & DL, respectively. Beginning in 1993 the baseline readjustment year will be indicated on baseline BM,s only indicated below (*). Henceforth all BM numbers will be labeled as a Y, G, or L, series that will no longer indicate the major adjustment year.

To facilitate the adjustment, indexing and distribution of adjusted values of the net, the county territory was divided into 33 quads or areas. For the identification purposes each quad was given a name, viz., "Rosemead," "La Mirada," "Santa Fe," etc. When bench marks and elevations in these quads are used, the name must be included in the bench mark description, e.g.,

* BASELINE 90.057 L&BR IN CTR OF CB RET @ NE COR Y 9191
(1990) 295.461 LA HABRA BLVD & VALLEY HOME AVE
10.7M N & 10.7M E/O C/L INT

It is expected that this general adjustment will for the most part remain sound for 8 to 12 years. Updating constrained adjustments will continue in the future. When a quad is readjusted, new elevations will be published and the date of readjustment will be noted in the bench mark description. Two bench marks with different adjustment dates will not normally agree with each other.

The basic accuracy of the net is reflected by an indicated field probable error of plus or minus ~~0.0034~~ 3.4mm per kilometer of leveling as determined from the conditions of closure. However, many years of experience in vertical control in the greater Los Angeles basin and Antelope Valley indicate that because of varying degrees of subsidence and heaving, the true datum is recovered only by obtaining substantial agreement of a number of bench marks.

The users of this net are invited to assist in its maintenance by notifying this department of cases of obliteration, apparent mistakes in description or elevations, and proven disturbance of bench marks.

=====
DATUM: North American Vertical Datum of 1988 (NAVD88)

Note: NAVD 1988 minus approximately 700mm (2.3ft) equals
Previous NGVD 1929 Datums. For more accurate equations
At individual bench marks refer to previous publications

ABBREVIATIONS USED IN BENCH MARK LISTINGS

ABUT -----	Abutment	ECR -----	End of Curb Return
ALG -----	Along	EC -----	End of Curve
ANG PT -----	Angle Point	ENT -----	Entrance
B/W -----	Back of Walk	FL -----	Floor
BCR -----	Beginning of Curb Return	FTG -----	Footing
BC -----	Beginning of Curve	FRWY -----	Freeway
BLDG -----	Building	F/W -----	Front of Walk
BM -----	Bench Mark	GAR -----	Garage
BT SPK -----	Boat or Bolt Spike	HDWL -----	Headwall
BR CAP -----	Brass or Bronze Cap	HSE -----	House
C B -----	Catch Basin	HWY -----	Highway
CTR -----	Center	INT -----	Intersection
C/L -----	Center Line	IP -----	Iron Pipe
C/L INT -----	Center Line Intersection	LT -----	Left
C/L PROD -----	Center Line Produced	LACE -----	L.A. City Engineer
CONC -----	Concrete	LACS -----	L.A. Co. Engineer
COR -----	Corner	LAFC -----	L.A. Co. Flood Control
COE -----	Corps of Engineers	L&BN -----	Lead and Bench Nail
CULV -----	Culvert	L&BR -----	Lead and Brad
CYN -----	Canyon	L&N -----	Lead and Nail
CB -----	Curb	L&SPK -----	Lead and Spike
CS MON -----	Co. Eng. Monument	L&T -----	Lead and Tack
CT SPK -----	Cut Spike	MCR -----	Middle of Curb Return
DPW -----	Dept. of Public Works	MKD -----	Marked
DR -----	Drive or Driveway	MC -----	Middle of Curve
E/O -----	East of	MON -----	Monument

ABBREVIATIONS USED IN BENCH MARKS (CON'T)

N/O ----- North of
NR ----- Near
OPP ----- Opposite
PI ----- Point of Intersection
PK&W ----- PK Nail and Washer
P/L ----- Property Line
POST ----- Point of Semi-Tangent
PP ----- Power Pole
PVMT ----- Pavement
PROD ----- Produced
RD ----- Road
RDBM ----- Road Dept. Bench Mark
RDBM TAG ----- Road Dept. Bench Mark Tag
RR ----- Railroad
RT ----- Right
R/W ----- Right of Way
SDMH ----- Storm Drain Manhole
SMH ----- Sewer Manhole
SPK ----- Spike
ST&W ----- Spike Tin and Washer
S/O ----- South of
TP ----- Telephone Pole
USC&GS ----- U.S. Coast and Geodetic Survey
USGS ----- U.S. Geological Survey
WK ----- Walk
W/O ----- West of

QUAD

SANTA FE

QUAD

NORWALK

ARTESIA QUAD

ARTESIA BLVD

LA MIRADA QUAD

COUNTY COUNTY

ANGELES BEACH

ORANGE

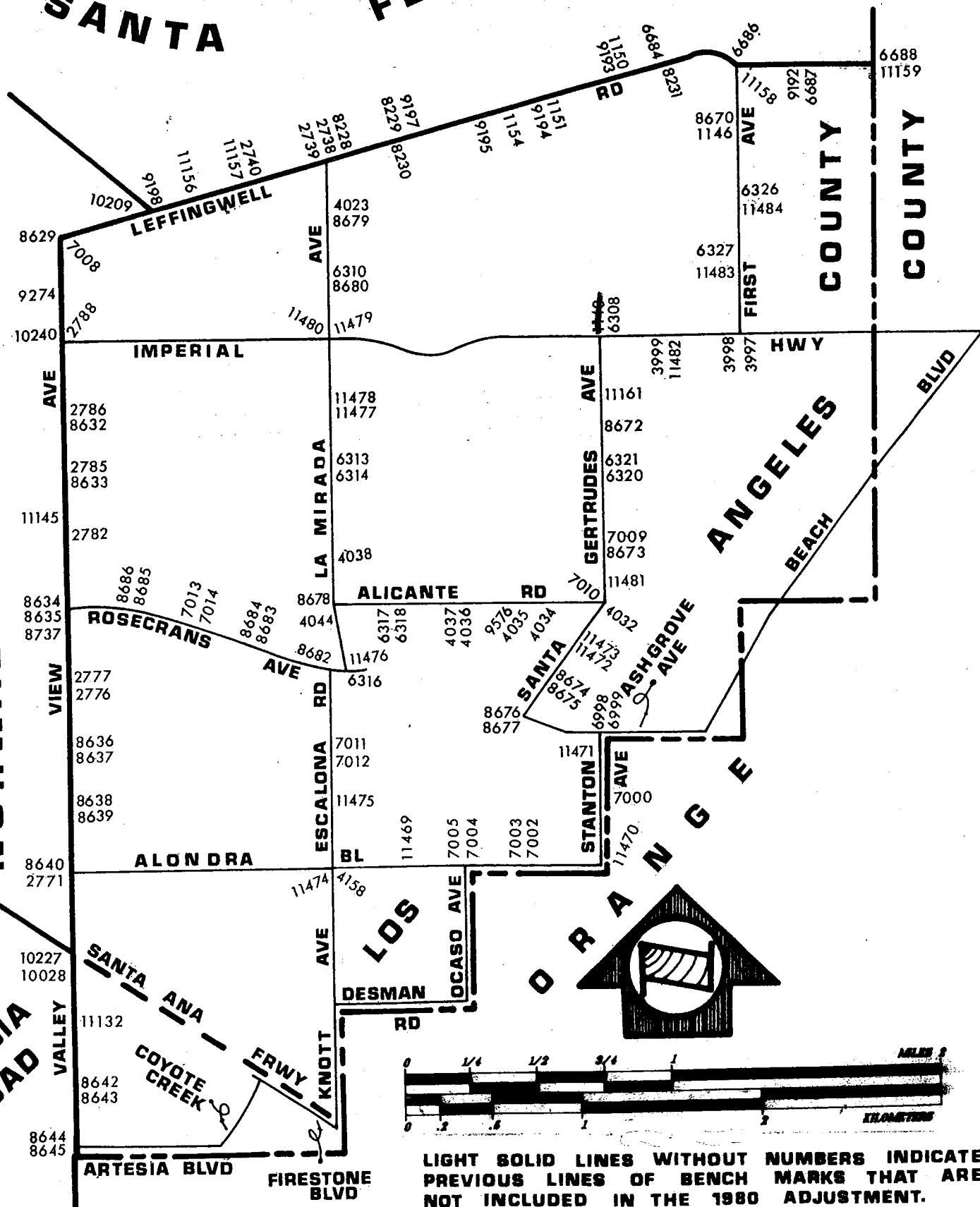

LIGHT SOLID LINES WITHOUT NUMBERS INDICATE PREVIOUS LINES OF BENCH MARKS THAT ARE NOT INCLUDED IN THE 1980 ADJUSTMENT.

QUAD YEAR	ELEV FOOT/METER	DESCRIPTION	BM NUMBER
LA MIRADA (2000)	259.041 78.956	CS MON IN WELL @ OR NR C/L INT IMPERIAL HWY & SANTA GERTRUDES AVE MKD (AUX-1 LA HABRA A-10A 1969 RE 5869)	Y 1140A
LA MIRADA (2000)	258.588 78.818	RDBM TAG IN W CB 300MM S/O BCR @ SW COR FIRST AVE & SHARONHILL DR 18M S & 10M W/O C/L INT	Y 1146
BASELINE (1995)	243.461 74.207	L&BN IN N CB W END C B 11M E/O BCR @ NE COR SANTA GERTRUDES AVE & LEFFINGWELL RD 44M E & 12M N/O C/L INT	Y 1150A
BASELINE (1995)	236.656 72.133	L&BN IN S CB LEFFINGWELL RD 12M S/O C/L & 12.5M E/O C/L PROD EL ARCO DR	Y 1151A
BASELINE (1995)	230.682 70.312	CS MON IN WELL 300MM S/O S CF (IN ISLE) 13M S/O C/L LEFFINGWELL RD OPP HSE #15462 & 188M E/O SCOTT AVE MKD (RM 2 LA HABRA A 9 1960)	Y 1154A
BASELINE (1995)	218.736 66.671	L&T IN CB DRWY 600MM E/O BCR @ NW COR LA MIRADA BL & LEFFINGWELL RD 12M N & 18M W/O C/L INT	Y 2738
BASELINE (1995)	218.848 66.705	L&T IN S CB 2M E/O BCR @ SW COR LEFFINGWELL RD & LA MIRADA BLVD 13M S & 15M W/O C/L INT	Y 2739
BASELINE (1995)	193.618 59.015	L&BN IN W END C B 12M N/O C/L LEFFINGWELL RD 39M W/O C/L DRWY @ W END APT BLDG #14905 (149M W/O C/L LA MIRADA BLVD)	Y 2740A
BASELINE (1995)	67.421 20.550	L&BN IN W CB RET 2M N/O BCR @ SW COR ALONDRA BL & VALLEY VIEW AVE 21M S & 12M W/O C/L INT	Y 2771A
BASELINE (1995)	96.798 29.504	L&SPK N CB 1M E/O BCR @ NE COR 8.5M N/O C/L STAGE RD & 31M E/O C/L VALLEY VIEW AVE MKD (RBM 1)	Y 2776A
BASELINE (1995)	96.840 29.517	USC&GS MON FL 2.7M E/O BCR 450MM N/O CF @ NE COR 33M E/O C/L VALLEY VIEW AVE & 9M N/O C/L STAGE RD MKD (K 788 1945)	Y 2777A
BASELINE (1995)	96.335 29.363	L&BN IN E CB 25M N/O BCR @ NE COR VALLEY VIEW AVE & MANSA DR 41M N & 12M E/O C/L INT (@ CTR BRIDGE OVER MILAN CREEK)	Y 2782B
BASELINE (1995)	96.791 29.502	CS MON IN WELL 300MM E/O E CF 600MM N/O BCR @ NE COR VALLEY VIEW AVE & FOSTER RD 19M N & 12M E/O C/L INT MKD (BM 1-6A 1961)	Y 2785A
BASELINE (1995)	108.064 32.938	L&BN E CB 300MM N/O BCR @ NE COR VALLEY VIEW AVE & ADOREE ST 17.4M N & 11.6M E/O C/L INT	Y 2786A
BASELINE (1995)	117.962 35.955	L&BN IN E CB 300MM S/O BCR @ SE COR VALLEY VIEW AVE & IMPERIAL HWY 23M S & 11.6M E/O C/L INT	Y 2788A
LA MIRADA (2000)	302.817 92.299	RDBM TAG IN S CB 300MM E/O BCR @ SE COR FIRST AVE & IMPERIAL HWY 17M E & 12M S/O C/L INT	Y 3997A
LA MIRADA (2000)	302.184 92.106	CS TRI MON IN WELL @ OR NR C/L INT IMPERIAL HWY & FIRST AVE MKD (LA HABRA AUX-1 B-10-A 1960)	Y 3998A
LA MIRADA (2000)	270.386 82.414	L&T IN S CB IMPERIAL HWY 12M S/O C/L & 14.6M W/O C/L PROD CLEARLEN AVE MKD (BM)	Y 3999
LA MIRADA (2000)	209.688 63.913	RDBM TAG IN E CB 600MM N/O BCR @ NE COR LA MIRADA BLVD & GRANADA AVE 12M E/O & 27M N/O C/L INT	Y 4023

QUAD YEAR	ELEV FOOT/METER	DESCRIPTION	BM NUMBER
LA MIRADA (2000)	225.390 68.699	L&BR IN S CB 3.4M E/O BCR @ SE COR ALICANTE RD & SANTA GERTRUDES AVE 29M E & 9M S/O C/L INT	Y 4032A
LA MIRADA (2000)	218.808 66.693	L&BN IN CB RET 600MM N/O BCR @ SW COR ALICANTE RD & MANCITA DR 14M S & 5.5M W/O C/L INT	Y 4034A
LA MIRADA (2000)	214.573 65.402	L&BN IN CB RET 600MM N/O BCR @ SE COR ALICANTE RD & LA MESA DR 14M S & 5.5M E/O C/L INT	Y 4035
LA MIRADA (2000)	182.854 55.734	L&BR IN CB RET 600MM N/O BCR @ SE COR ALICANTE RD & ADELFA DR 14M S & 5.5M E/O C/L INT	Y 4036
LA MIRADA (2000)	181.660 55.370	L&BN IN IN CB RET 600MM N/O BCR @ SW COR ALICANTE RD & ADELFA DR 14M S & 5.5M W/O C/L INT	Y 4037
LA MIRADA (2000)	148.313 45.206	L&NAIL IN W CB 12M W/O & 30M S/O C/L INT LA MIRADA BLVD & WHITEROCK DR IN FRONT PP #1063580E	Y 4038
LA MIRADA (2000)	143.353 43.694	L&BN IN W CB 12M W/O & 61M S/O C/L INT LA MIRADA BLVD & ALICANTE RD IN FRONT PP #1081377E	Y 4044
LA MIRADA (2000)	113.438 34.576	CS MON IN WELL 75MM DN @ C/L INT ALONDRA BLVD & ESCALONA RD MKD (22-23-27-26) RESET	Y 4158
LA MIRADA (2000)	259.789 79.184	L&BN IN CTR OF CB RET @ NE COR IMPERIAL HWY & SANTA GERTRUDES AVE 15M N & 12M E/O C/L INT	Y 6308
LA MIRADA (2000)	196.322 59.839	L&BN IN E CB 12M E/O C/L LA MIRADA BLVD & 11M S/O C/L S ENT DRWY TO CHURCH PARKING LOT @ 12000 LA MIRADA BLVD	Y 6310
LA MIRADA (2000)	157.227 47.923	L&T E CB 300MM N/O BCR @ NE COR LA MIRADA BLVD & FOSTER RD 20M N & 12M E/O C/L INT	Y 6313
LA MIRADA (2000)	157.752 48.083	CO ENG TAG 1.5M E/O BCR @ SE COR LUITWIELER BLVD & FOSTER RD 10M S & 24M E/O C/L INT	Y 6314
LA MIRADA (2000)	130.984 39.924	RDBM TAG IN W CB 3.7M S/O BCR @ SW COR ROSECRANS AVE & LA MIRADA BLVD 12M W & 26.5M S/O C/L INT	Y 6316
LA MIRADA (2000)	141.069 42.998	RDBM TAG S CB 450MM W/O BCR @ SW COR ALICANTE RD & BLUEFIELD AVE 6M S & 14M W/O C/L INT	Y 6317
LA MIRADA (2000)	142.260 43.361	L&PK S CB 300MM E/O BCR @ SE COR ALICANTE RD & BLUEFIELD AVE 6M S & 14M E/O C/L INT	Y 6318
LA MIRADA (2000)	265.488 80.921	L&BR IN E CB (SERV RD) 1.5M N/O BCR @ SE COR FOSTER RD & SANTA GERTRUDES AVE 4.5M E & 10M S/O C/L INT MKD (BM)	Y 6320
LA MIRADA (2000)	265.646 80.969	L&T IN E CB (SERV RD) 1.5M N/O BCR @ NE COR FOSTER RD & SANTA GERTRUDES AVE 5.6M E & 13.7M N/O C/L INT MKD (BM)	Y 6321
LA MIRADA (2000)	252.942 77.097	CSBM BR DISK IN S END C B @ FC CHANNEL 10M E/O C/L FIRST AVE & 72M N/O C/L AMBER VALLEY DR MKD (BM 13-15A 1961 RE 5869)	Y 6326
LA MIRADA (2000)	275.724 84.041	RDBM TAG IN W CB 300MM N/O BCR @ NW COR FIRST AVE & CANDLELIGHT DR 18M N & 10M W/O C/L INT	Y 6327

QUAD YEAR	ELEV FOOT/METER	DESCRIPTION	BM NUMBER
BASELINE (1995)	256.010 78.032	L&BN IN SLY CB 600MM E/O C B 12M S/O C/L LEFFINGWELL RD & 55M E/O C/L LAMBERT RD	Y 6684
BASELINE (1995)	269.291 82.080	RDBM TAG IN N CB 600MM E/O 1ST C B @ NE COR FIRST AVE & LEFFINGWELL RD 34.4M E & 11.6M N/O C/L INT	Y 6686
BASELINE (1995)	281.302 85.741	L&T IN S CB 1.5M E/O BCR @ SE COR LEFFINGWELL RD & TIGRINA AVE 15M W & 10.7M S/O C/L INT	Y 6687
BASELINE (1995)	295.934 90.201	L&BN IN N CB 600MM E/O BCR @ NW COR LEFFINGWELL RD & VALLEY HOME AVE 14.6M W & 10.4M N/O C/L INT	Y 6688
LA MIRADA (2000)	135.889 41.419	L&BN IN N CB 300MM E/O BCR @ NE COR ASHGROVE DR & STANTON AVE 15M E & 9M N/O C/L INT MKD (BM)	Y 6998
LA MIRADA (2000)	135.091 41.176	L&BN IN W CB 300MM N/O BCR @ SW COR ASHGROVE DR & STANTON AVE 13.4M S & 6M W C/L INT MKD (BM)	Y 6999
LA MIRADA (2000)	116.266 35.438	L&BN IN W CB 14M S & 6M W APPROX P I STANTON AVE & CALVERTON DR @ FIRE HYD HSE #15405 MKD BM	Y 7000
LA MIRADA (2000)	117.749 35.890	CS TAG NELY CB 12M NLY BCR @ NELY COR ALONDRA BLVD & LA MIRADA BLVD 30.5M NWLY & 11M NELY C/L INT	Y 7002
LA MIRADA (2000)	119.803 36.516	CS TAG NLY CB 600MM WLY BCR @ NWLY COR ALONDRA BLVD & LA MIRADA BL 12M NLY & 37M WLY C/L INT	Y 7003
LA MIRADA (2000)	117.099 35.692	L&T IN N CB 12M N & 9M W/O C/L INT ALONDRA BLVD & OCASO AVE	Y 7004
LA MIRADA (2000)	117.198 35.722	L&T IN S CB 600MM W/O BCR @ SW COR ALONDRA BLVD & OCASO AVE 12M S & 17M W/O C/L INT	Y 7005
BASELINE (1995)	164.550 50.155	L&BR IN E CB 3.7M S/O BCR @ NE COR VALLEY VIEW AVE & LEFFINGWELL RD 28M N & 12.8M E/O C/L INT	Y 7008
LA MIRADA (2000)	227.644 69.386	L&T IN W CB 12M N/O N END C B & 10M W/O C/L SANTA GERTRUDES AVE 78M N/O AVENIDA SANTA TECLA MKD (BM)	Y 7009
LA MIRADA (2000)	231.089 70.436	L&BR IN N CB 12M W/O BCR @ NW COR ALICANTE RD & SANTA GERTRUDES AVE 26.5M W & 6M N/O C/L INT	Y 7010
LA MIRADA (2000)	119.681 36.479	L&BN IN E CB 1.5M N/O BCR @ NE COR EXCELSIOR DR & ESCALONA RD 15M N & 5.5M E/O C/L INT	Y 7011
LA MIRADA (2000)	121.725 37.102	L&BN IN E CB 300MM S/O BCR @ SE COR EXCELSIOR RD & ESCALONA RD 14M S & 5.5M E/O C/L INT	Y 7012
LA MIRADA (2000)	111.784 34.072	L&BN IN S CB ROSECRANS AVE 600MM W/O BCR @ SW COR BIOLA AVE 26M W & 11.6M S/O C/L INT MKD (BM)	Y 7013
LA MIRADA (2000)	111.118 33.869	L&BN IN N CB ROSECRANS AVE 600MM E/O BCR @ NE COR BIOLA AVE 20M E & 12M N/O C/L INT MKD (BM)	Y 7014
BASELINE (1995)	218.080 66.471	CS MON IN WELL 4.6M E/O BCR 2M S/O CF @ SW COR LEFFINGWELL RD & LA MIRADA BLVD 19.5M W & 15M S/O C/L INT MKD (K9-1960)	Y 8228
BASELINE (1995)	226.857 69.146	L&BN IN W CB 4M N/O BCR @ NW COR LEFFINGWELL RD & STAMEY RD 24M N & 5.5M W/O C/L INT	Y 8229

NAVD 88 DATUM

QUAD YEAR	ELEV FOOT/METER	DESCRIPTION	BM NUMBER
BASELINE (1995)	227.109 69.223	L&BR IN S CB LEFFINGWELL RD 13M S/O C/L & 12M E/O C/L PROD STAMEY RD (FR THE N)	Y 8230
BASELINE (1995)	256.079 78.053	CS BM MON FL IN CTR OF ISLAND LEFFINGWELL RD 52M E/O C/L LAMBERT RD MKD (BM 4-18 1965)	Y 8231
BASELINE (1995)	159.655 48.663	L&BN IN E CB 300MM S/O BCR @ SE COR VALLEY VIEW AVE & LEFFINGWELL RD 18M S & 13M E/O C/L INT	Y 8629
BASELINE (1995)	105.108 32.037	RDBM TAG IN W CB VALLEY VIEW AVE 11.6M W/O C/L & 8M S/O C/L PROD ADOREE ST (FR THE E)	Y 8632
BASELINE (1995)	97.283 29.652	L&T IN W CB 600MM S/O BCR @ SW COR VALLEY VIEW AVE & FOSTER RD 17.4M S & 12M W/O C/L INT	Y 8633
BASELINE (1995)	115.433 35.184	L&BN IN E CB 300MM N/O BCR @ NE COR VALLEY VIEW AVE & ROSECRANS AVE 23.5M N & 12M E/O C/L INT	Y 8634
BASELINE (1995)	113.832 34.696	L&T CB IN RET 6M N/O BCR @ SW COR VALLEY VIEW AVE & ROSECRANS AVE 17M S & 15M W/O C/L INT	Y 8635
BASELINE (1995)	82.024 25.001	RDBM TAG E CB 2M N/O BCR @ NE COR VALLEY VIEW AVE & GANNET ST 21M N & 11.6M E/O C/L INT	Y 8636
BASELINE (1995)	81.493 24.839	RDBM TAG IN N CB 600MM W/O BCR @ NW COR VALLEY VIEW AVE & GANNET ST 24M W & 8M N/O C/L INT	Y 8637
BASELINE (1995)	76.184 23.221	CS MON FL IN CONC ABUT 2M E/O CF @ NE COR BRIDGE #1262 OVER LA MIRADA CREEK 14M E/O C/L VALLEY VIEW AVE (BM 1-2A 1968 RE 5869)	Y 8638
BASELINE (1995)	75.955 23.151	L&BN IN CHIS SQ W CB 12M W/O C/L VALLEY VIEW AVE 450MM N/O L&T 7M S/O N ABUT OF BRIDGE OVER LA MIRADA CREEK	Y 8639
BASELINE (1995)	69.009 21.034	L&T IN N CB 600MM E/O BCR @ NE COR VALLEY VIEW AVE & ALONDRA BLVD 23M E & 12M N/O C/L INT	Y 8640
BASELINE (1995)	59.813 18.231	RDBM TAG IN E CB VALLEY VIEW AVE 13M E/O C/L & 2.4M N/O C/L PROD PARK PL (@ S END C B)	Y 8642
BASELINE (1995)	58.884 17.948	RDBM TAG IN S CB 1M W/O BCR @ SW COR VALLEY VIEW AVE & PARK PL 24M W & 6.7M S/O C/L INT	Y 8643
BASELINE (1995)	56.706 17.284	CS BM MON IN S END C B 1.2M N/O BCR @ NW COR ARTESIA BLVD & VALLEY VIEW AVE 25M N & 13M W/O C/L INT MKD (BM 8-1A 1968 RE 5869)	Y 8644
BASELINE (1995)	56.443 17.204	RDBM TAG IN N CB 600MM E/O BCR @ NE COR ARTESIA BLVD & VALLEY VIEW AVE 24M E & 13M N/O C/L INT	Y 8645
LA MIRADA (2000)	259.733 79.167	RDBM TAG IN W CB (SERV RD) 600MM N/O BCR @ NW COR FIRST AVE & SHARONHILL DR 21M W & 14M N/O C/L INT	Y 8670
LA MIRADA (2000)	267.955 81.673	L&T IN WALK 2M E/O E CF SANTA GERTRUDES AVE 12M E/O C/L & 13.7M E/O C/L PROD GAZEBROOK DR MKD BM	Y 8672
LA MIRADA (2000)	227.562 69.361	L&T IN E CB 57M N/O BCR @ NE COR SANTA GERTRUDES AVE & AVENIDA SANTA TECLA 78M N & 10M E/O C/L INT MKD (BM)	Y 8673

QUAD YEAR	ELEV FOOT/METER	DESCRIPTION	BM NUMBER
LA MIRADA (2000)	183.264 55.859	RDBM TAG IN E CB 1.8M N/O BCR @ NE COR ROSECRANS AVE & SANTA GERTRUDES AVE 34M N & 9M E/O C/L INT	Y 8674
LA MIRADA (2000)	180.659 55.065	RDBM TAG IN S CB 3M W/O BCR @ SE COR ROSECRANS AVE & SANTA GERTRUDES AVE 18.6M E & 12M S/O C/L INT	Y 8675
LA MIRADA (2000)	165.593 50.473	RDBM TAG IN W CB 300MM N/O BCR @ NW COR ASHGROVE DR & SANTA GERTRUDES AVE 17M N & 9M W/O C/L INT	Y 8676
LA MIRADA (2000)	165.321 50.390	RDBM TAG IN S CB 1M E/O BCR @ SE COR ASHGROVE DR & GERTRUDES AVE 21M E & 5.5M S/O C/L INT	Y 8677
LA MIRADA (2000)	147.037 44.817	S&L IN S CB 1.5M E/O BCR @ SE COR LA MIRADA BL & ALICANTE RD 6M S & 25M E/O C/L INT	Y 8678
LA MIRADA (2000)	210.954 64.299	RDBM TAG IN S CB 600MM E/O BCR @ SE COR GRANADA AVE & MIRADA BLVD 6M S & 20M E/O C/L INT	Y 8679
LA MIRADA (2000)	196.285 59.828	RDBM TAG IN W CB 12M W/O C/L LA MIRADA BLVD & 11M S/O S ENT DRWY TO CHURCH PARKING LOT @ 12000 LA MIRADA BLVD	Y 8680
LA MIRADA (2000)	125.820 38.350	RDBM TAG IN N CB OF S (SERV RD) 16M S & 4M W/O C/L INT ROSECRANS AVE & ESCALONA RD	Y 8682
LA MIRADA (2000)	108.297 33.009	RDBM TAG IN S CB 600MM E/O BCR @ SE COR ROSECRANS AVE & FIGUERAS RD 12M S & 17M E/O C/L INT	Y 8683
LA MIRADA (2000)	108.021 32.925	L&BN IN N CB 600MM W/O BCR @ NW COR OF ROSECRANS AVE & FIGUERAS RD 12M N & 21M W/O C/L INT	Y 8684
LA MIRADA (2000)	118.848 36.225	RDBM TAG IN S CB 600MM E/O BCR @ SE COR ROSECRANS AVE & CASTELLON RD 24M S & 15M E/O C/L INT	Y 8685
LA MIRADA (2000)	119.242 36.345	L&BR IN S CB 600MM W/O BCR ISL @ SW COR ROSECRANS AVE & CASTELLON RD 13M S & 11.3M W/O C/L INT	Y 8686
BASELINE (1995)	112.670 34.342	CSBM MON FL 300MM S/O CF 32M W/O BCR @ SE COR VALLEY VIEW AVE & ROSECRANS AVE 52M W & 12.5M S C/L INT MKD (BM 7-60 1970)	Y 8737
BASELINE (1995)	280.901 85.619	L&T IN S CB 5M W/O BCR @ SW COR LEFFINGWELL RD & TIRGINA AVE 15M W & 12M S/O C/L INT	Y 9192
BASELINE (1995)	242.545 73.928	SPIT IN CB 10.4M W/O BCR @ NW COR LEFFINGWELL RD SANTA GERTRUDES AVE 25M W & 12M N/O C/L INT MKD (SD 729)	Y 9193
BASELINE (1995)	236.400 72.055	FC MON @ BK C B 13.4M S/O C/L LEFFINGWELL RD & 2.4M E/O C/L PROD EL ARCO DRIVE	Y 9194
BASELINE (1995)	226.817 69.134	LACE TAG IN S CB 3.7M E/O BCR @ SE COR LEFFINGWELL RD & SCOTT RD 13M S & 12.5M E/O C/L INT	Y 9195
BASELINE (1995)	226.397 69.006	CSBM MON IN WELL 300MM N/O N CF 300MM E/O BCR @ NE COR LEFFINGWELL RD & STAMEY RD 17.4M E & 13M N/O C/L INT MKD (BM 4-3B 1970)	Y 9197

QUAD YEAR	ELEV FOOT/METER	DESCRIPTION	BM NUMBER
BASELINE (1995)	189.904 57.883	CSBM MON FL 600MM N/O CF 600MM E/O BCR @ NE COR LEFFINGWELL RD & TELEGRAPH RD 13M N & 14.6M E/O C/L INT MKD (BM 1-9D 1965 RE 5869)	Y 9198
BASELINE (1995)	147.408 44.930	RDBM TAG IN W CB VALLEY VIEW AVE 13M W/O C/L & 2.7M S/O C/L CUL-DE-SAC CHERE DR (FR THE W) 322M S/O LEFFINGWELL RD	Y 9274
LA MIRADA (2000)	214.907 65.504	RDBM TAG IN S CB 600MM W/O BCR @ SW COR ALICANTE RD & LA MESA DR 6M S & 13M W/O C/L INT	Y 9576
BASELINE (1995)	63.980 19.501	L&BR IN N CB 2.4M E/O BCR @ NE COR VALLEY VIEW AVE & FIRESTONE BLVD 23M E & 8M N/O C/L INT (SOUTH SIDE OF (5) SANTA FRWY)	Y 10028
BASELINE (1995)	186.961 56.986	RDBM TAG IN S CB RET 300MM W/O BCR @ SE COR 30M E/O C/L TELEGRAPH RD & 13M S/O C/L LEFFINGWELL RD	Y 10209
BASELINE (1995)	217.888 66.388	DPW BM TAG IN CONC BASE TRAFFIC SIGNAL 8M N/O C/L PROD FIRESTONE BLVD & 13M W/O C/L VALLEY VIEW AVE (S SIDE 5 FRWY)	Y 10227
BASELINE (1995)	119.449 36.408	MWD RP TAG IN S CB RET 1.5M E/O BCR @ SW COR VALLEY VIEW AVE & IMPERIAL HWY 21.6M W & 13M S/O C/L INT	Y 10240
BASELINE (1995)	60.905 18.564	DPW BM TAG IN W CB 1M S/O BCR @ SW COR VALLEY VIEW AVE & ARBOR PL 18M S & 13M W/O C/L INT	Y 11132
BASELINE (1995)	97.237 29.638	L&T IN E CB 600MM N/O BCR @ NE COR VALLEY VIEW AVE & MANSA DR 17M N & 12M E/O C/L INT	Y 11145
BASELINE (1995)	205.853 62.744	DPW BM TAG IN N CB 1M W BCR @ NW COR LEFFINGWELL RD & DOUBLE EAGLE DR 12M N & 9.4M W/O C/L INT	Y 11156
BASELINE (1995)	188.366 57.414	L&BN IN S CB 300MM W/O BCR @ SW COR LEFFINGWELL RD & ARROYO DR 16M W & 12M S/O C/L INT	Y 11157
BASELINE (1995)	268.963 81.980	DPW BM TAG IN S CB 2M E/O BCR @ SE COR LEFFINGWELL RD & FIRST AVE 26M E & 12M S/O C/L INT	Y 11158
BASELINE (1995)	297.814 90.774	ORANGE CO BM DISC IN N CB W END C B @ BCR NE COR LA HABRA BLVD & VALLEY HOME AVE 14M E & 9M N/O C/L INT MKD (BM 2K-21-75)	Y 11159
LA MIRADA (2000)	270.285 82.383	L&T IN E CB RET 300MM N/O BCR @ SE COR LAWNHILL DR & SANTA GERTRUDES AVE 16M S & 10M E/O C/L INT	Y 11161
LA MIRADA (2000)	118.920 36.247	LACO BM TAG IN N CB (SERV RD) ALONDRA BLVD 4.7M N/O C/L & 6M E/O C/L BLUEFIELD AVE	Y 11469
LA MIRADA (2000)	106.519 32.467	L&T IN ELY CB CALVERTON DR ON C/L PROD ALONDRA BLVD 71M SLY/O C/L HAYFORD ST	Y 11470
LA MIRADA (2000)	128.274 39.098	LACO BM TAG IN E CB @ LT STD HSE #4602 STANTON AVE 6M E/O C/L	Y 11471
LA MIRADA (2000)	221.525 67.521	LACO BM TAG IN W CB SANTA GERTRUDES AVE 9.4M W/O C/L & 157M S/O C/L ALICANTE RD (23M S/O BC)	Y 11472
LA MIRADA (2000)	222.145 67.710	LACO BM TAG IN E CB SANTA GERTRUDES AVE 9.4M E/O C/L & 142M S/O C/L ALICANTE RD (10M S/O BC)	Y 11473

NAVD 88 DATUM

QUAD YEAR	ELEV FOOT/METER	DESCRIPTION	BM NUMBER
LA MIRADA (2000)	113.504 34.596	LACO BM TAG IN E CB S END C B @ NE COR ALONDRA BLVD & ESCALONA RD 37M N & 6M E/O C/L INT	Y 11474
LA MIRADA (2000)	115.590 35.232	LACO BM TAG IN E CB 1M N/O BCR @ NE COR ESCALONA RD & BARNWALL ST 15M N & 5.5M E/O C/L INT	Y 11475
LA MIRADA (2000)	130.659 39.825	LACO BM TAG IN E CB 1M N/O BCR @ NE COR LA MIRADA AVE & ROSECRANS AVE 26.6M N & 12M E/O C/L INT	Y 11476
LA MIRADA (2000)	178.759 54.486	L&BN IN W CB 300MM S/O BCR @ SW COR TACUBA DR & LA MIRADA BLVD (SERV RD) 4.7M W & 14.5M S/O C/L INT	Y 11477
LA MIRADA (2000)	179.265 54.640	LACO BM TAG IN E CB 300MM N/O BCR @ SE COR TACUBA DR & LA MIRADA BLVD 16M S & 12.6M E/O C/L INT	Y 11478
LA MIRADA (2000)	193.530 58.988	L&T IN N CB 300MM W/O BCR @ NW COR LA MIRADA BLVD & IMPERIAL HWY 13M N & 23.5M W/O C/L INT	Y 11479
LA MIRADA (2000)	194.570 59.305	LACO BM TAG IN E CB 16M N/O BCR @ NE COR LA MIRADA BLVD & IMPERIAL HWY 39.5M N & 12.5M E/O C/L INT	Y 11480
LA MIRADA (2000)	228.943 69.782	LACO BM TAG E CB 100MM N/O BCR @ NE COR SANTA GERTRUDES AVE & AVENIDA SANTA TECLA AVE 23M N & 10M E/O C/L INT	Y 11481
LA MIRADA (2000)	291.731 88.920	30MM BUTTON BRASS CAP 400MM S/O S CF @ BCR SW COR IMPERIAL HWY & GROVEDALE DR 18M W & 13M S/O C/L INT MKD (2016 091901A)	Y 11482
LA MIRADA (2000)	278.926 85.017	LACO TAG IN W CB 600MM S/O BCR @ SW COR FIRST ST & CANDLELIGHT DR 17M S & 10M W/O C/L INT	Y 11483
LA MIRADA (2000)	257.315 78.430	LACO DPW TAG IN N CB 1M E/O BCR @ NE COR FIRST ST & AMBER VALLEY DR 22M E & 6M N/O C/L INT	Y 11484